

Public Input Map Summary

September 2019 Outreach Meetings



Summary of map comments and online input from 10 meetings held across Jackson during the month of September 2019

Updated 10/01/19

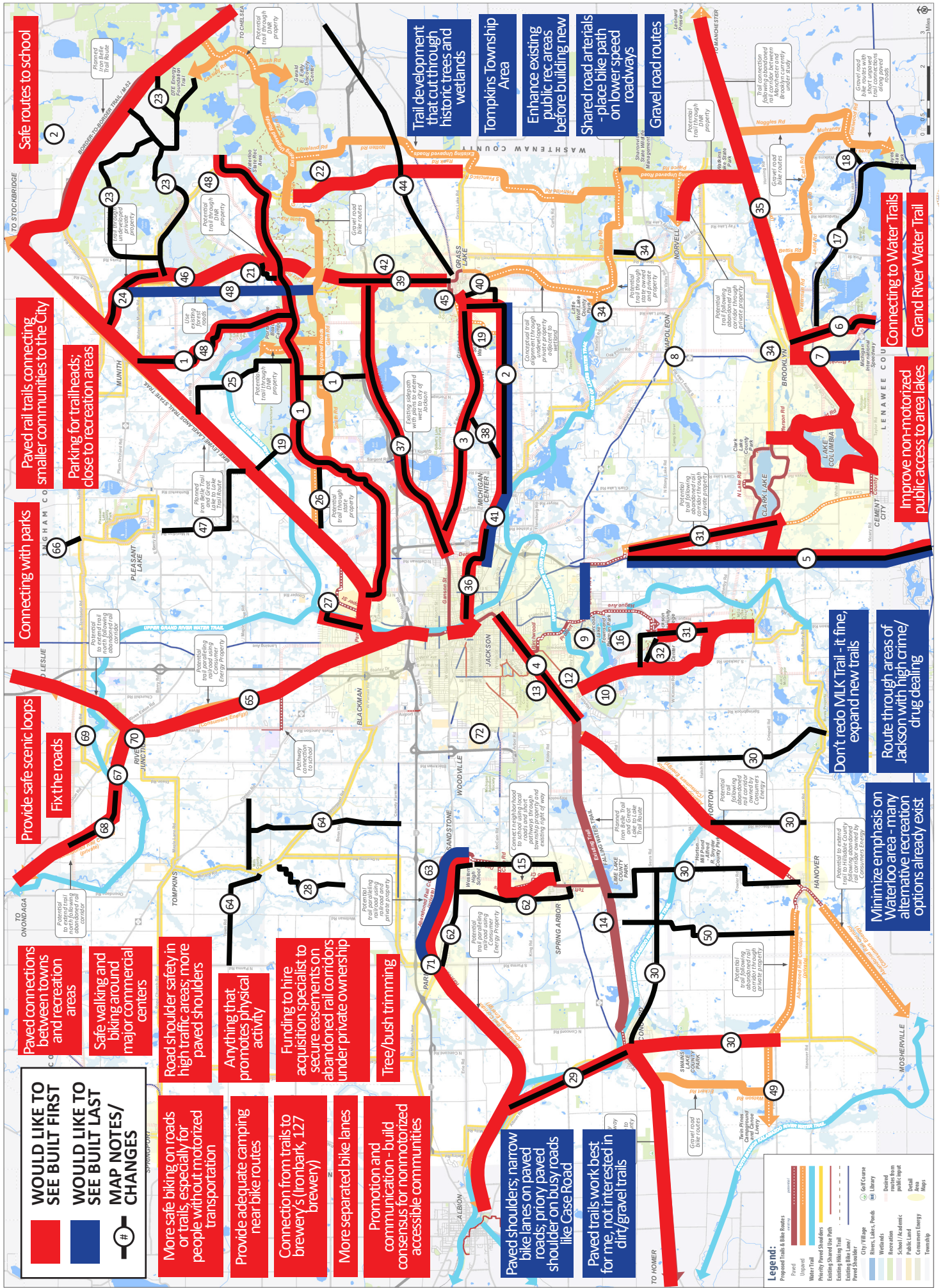

JACKSON COUNTY - MAP NOTES/CHANGES:

1. Add bike route to priority paved shoulders (Coonhill Rd, Portage Lake Rd, Seymour Rd, Leary Rd, Clear Lake Rd, Race Road); maybe consider adding in Seymour Road with a paved shoulder - it is a popular road for road cyclists and is used during the OHR ride; Seymour needs bike lanes - scenic road; Seymour road has a lot of cyclists and a lot of vehicle use, needs a paved shoulder. Lots of riders use Race Road.
2. Page Avenue connection paved shoulder instead of sidepath; not many stops along Page Ave
3. More separation between shoulder and road on Michigan Ave - currently too narrow
4. Redo intercity trail to improve safety and access
5. Pathway along right-of-way of 127; existing wide right-of-way; use 127 connection to Cement City instead of abandoned rail corridor that is in private ownership
6. Use Monroe Pike as main connection to Michigan International Speedway
7. Bike rack at Market in Brooklyn
8. Napoleon needs sidewalks on main drag (M-50)
9. Hinkley from Ella Sharp to MLK
10. Follow sewer line to connect neighborhoods along west side of Jackson Road, may also be potential for trail connection across Golf Course to Horton Road; Cascades Golf Course Service Drive, connect Wallace St to Warren and Denton Roads
11. Connection from Jackson College to MacCready Reserve via Browns Lake Road and Skiff Lake
12. Current bike crossing at Weatherwax and Horton is dangerous, when cars are turning from NE bound Horton onto Weatherwax they do not see existing rectangular rapid flash beacon.
13. Extend Wallace east to Kibby Road and add non motorized pathway from Wallace to Cascades Park/Trails and Falling Waters Trail
14. Add a spur to the Township Park (corner of Hammond Rd and Cross Rd) from Falling Waters Trails
15. Spring Arbor: Use Dearing Road as connection to Western School Campus (proposed neighborhood route challenging, opposition by private owners); Dearing Rd at McCain Road is a bad corner, keep trail on west side; dual enrollment between College and High School
16. Like to see college to Falling River connection located along Browns Lake Road
17. Highlight enhanced paved shoulders connection on Wamplers Lake Road; add note on Wamplers road to provide separated bikeway away from the road next time it is reconstructed
18. Better connection to Hayes State Park – continue along Wellwood Road, instead of along Ayes Road
19. Loop around State Game Area
20. Connection to Haenle Sanctuary Parking Lot
21. Use route along Wild Turkey and Trist Road instead of building trail through DNR land
22. Harvey Road key section – continue paved shoulder into Washtenaw County
23. Provide multiple loops around the Waterloo State Rec Area – following mostly unpaved roads in Jackson and Washtenaw Counties
24. Remove route
25. Potential connection along paved and unpaved roads to Lakelands Trail (Welch Lake Road, Dunn Road, Coon Hill)
26. Remove route
27. Make connection to future trail head for water trail – may be opportunity to follow proposed route behind neighborhoods on west side of the river then cross to make connection to trailhead
28. N Dearing Road very busy between Springport Rd and County Farm Road – Stepladder Road is a beautiful route and may be a better alternative
29. Would like to see paved off-road trail connection along Albion Road as Great Lake to Lake Trail Route; would like to see loop trail between Albion, Concord, Parma and Spring Arbor; Albion Road is nice but narrow
30. Rountree Road, Bowerman Road, Sears Road and Thorne road would provide great priority paved shoulder routes – Pulaski Road has high speeds; connection to High School on Moscow Rd
31. Prefer paved shoulder connection to Jackson College and Dahlem Nature Center along Browns Lake Road and Wickwire; proposed route along Jackson Road too busy
32. Provide paved trail connection through Dahlem Nature Center to Jackson Community College
33. Would like to see a paved trail between Brooklyn/Clark Lake Area and City of Jackson preferably along abandoned rail corridor – 127 right-of-way would not be pleasant
34. Water trailhead planned at Ford Plant in Brooklyn and at Little Wolf Lake; also may be potential for trailhead at Ahrens Park in Norvell Twp.
35. Would like to see Watkins Lake Trail remain unpaved
36. Important link – from Page Ave to Downtown Jackson
37. Priority route – Ann Arbor Road between Jackson and Grass Lake Twp
38. Used to be a snowmobile trail along Michigan Ave and Railroad
39. Priority route – Mount Hope Road between Grass Lake and trails north of I-94
40. Potential link into Grass Lake along Grosvenor and Burtch Road
41. Existing trail in Michigan Center a mess – too many driveways
42. Future Henry Ford Medical Center planned for southeast corner of Mount Hope Road and I-94
43. Dog attacks on Moeckel Rd
44. Any potential for connection along railroad from Jackson to Ann Arbor through Grass Lake?
45. Complete sidewalk gaps in Grass Lake
46. Bridge out
47. Provide some connection from Pleasant Lake area to Lakelands Trail
48. Mount Hope Road has high traffic, trucks avoiding scales on I-94 use this route – Coon Hill and Portage Lake have lower traffic volumes; Waterloo-Munith Road has less traffic as well
49. Some owners along railroad route may be open to pathway connection
50. Potential route along mostly gravel roads; lot of people use Cross Road to get to Falling Water Trail
51. Adequate camping near bike routes
52. More trash cans, bathrooms and bike racks along trails
53. Maintain paths into future
54. Online trail map (include water trails)
55. Concerns with speeds on local roads
56. More rental bikes – including recumbent and elliptical bikes
57. Mark staging areas and trailheads
58. Horse trails parallel to bike trails
59. Stuff along the trail
60. Concerns for maintaining horse/riding routes
61. Seating along trails for walkers
62. Use Chapel Rd and Michigan Ave to make connection from Falling Waters trail, through Spring Arbor/Western High School, to Parma; do not use Dearing, too busy
63. Large company with 600-700 employees
64. Nice on-road bicycle routes
65. Some wet areas
66. Priority paved shoulder on N Meridian Road from Pleasant Lake to Meridian-Baseline State Park Entrance in Henrietta Twp
67. Old railroad tressel
68. May be support of private owners along abandoned rail corridor
69. township just bought 17 acres along river
70. County owns some foreclosure property
71. Top priority (2020) - widen sidewalk across railroad along N Parma Road in Parma
72. Paved shoulders on Robinson Road

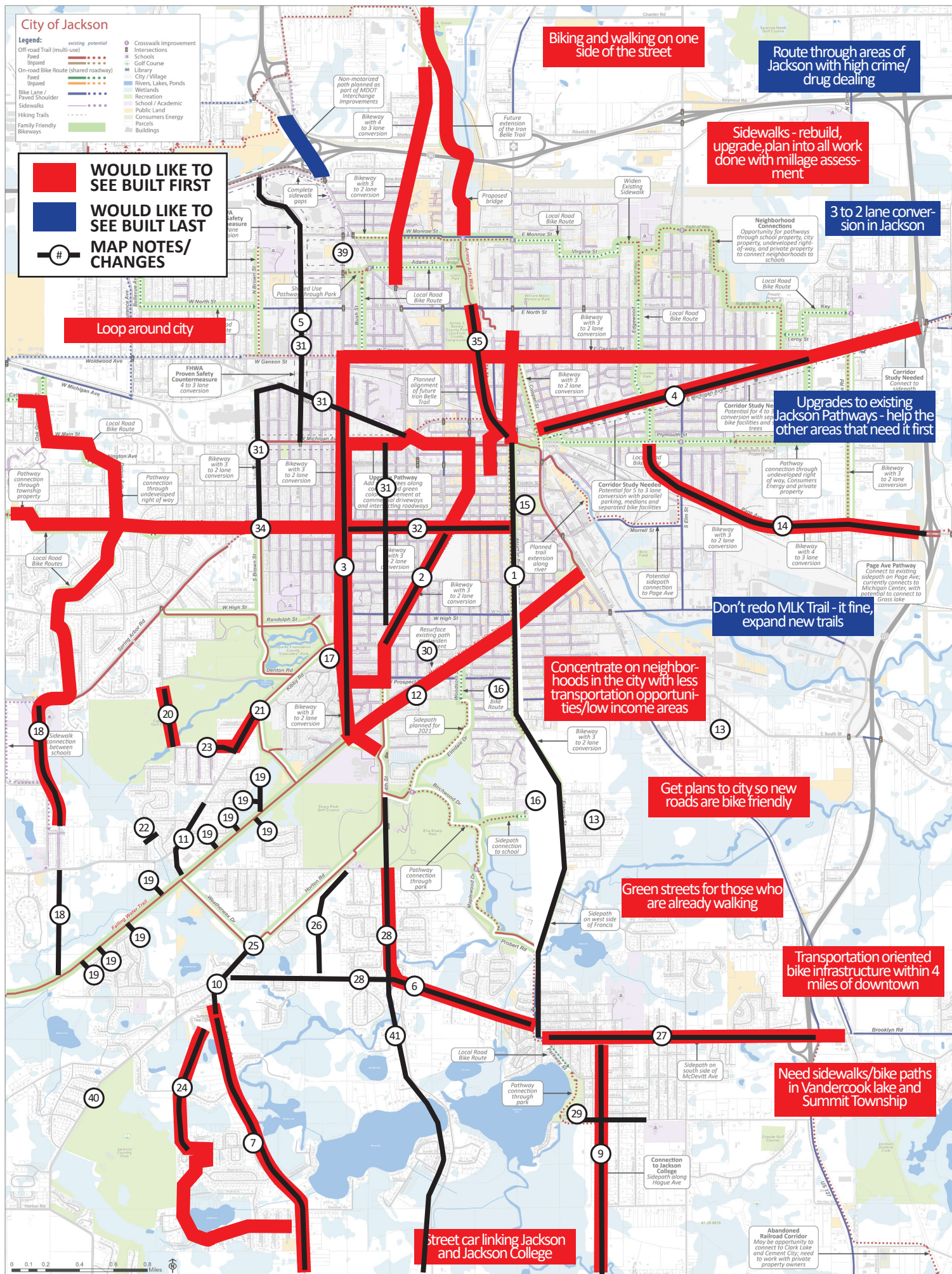

CITY OF JACKSON - MAP NOTES/CHANGES:

1. MLK - key transit corridor, spur residential redevelopment, continue on Hague for connection to Jacksons Campus; need to continue trail connection south to Hinkley and provide connection to grocery store
2. Greenwood Ave - infill development focus;
3. S. West Street - would be good proof of concept
4. Michigan Ave - focus on infill development
5. Is this possible for Green Street? Connection to shopping/commercial area needed
6. Provide connection along Badgley/Hinkley between S Jackson Road and Francis St (sidewalk/paved shoulder/trail); a very minimum a crosswalk is needed between Kathmar and Harriet Dr
7. S Jackson - scenic road, provide paved shoulder or trail
8. Browns Lake Road – scenic but not utilitarian, tight passing between lakes
9. Hague Ave – more of a utilitarian route over S Jackson Road, connects to Jackson College Campus
10. Priority link for trail
11. Paved Shoulder – connection to Kibby Cobb
12. Existing connection to Falling Waters Trail at end of W South St
13. No sidewalks in Neighborhoods
14. Potential family friendly routing on Page Ave
15. Remove School
16. Existing/Future School
17. Potential for dog park with trailhead
18. SRTS – going after grant to make connection from Spring Arbor Road to Blue Lane/Dresden Dr; potential to continue route south of Kibby Road following water main all the way to Falling Water Trails
19. Provide connection to Falling Waters Trail to neighborhood
20. Potential connection between neighborhoods using service road through Cascades Golf Course
21. Existing Crosswalk
22. Potential connection between neighborhoods
23. Potential to extend Wallace Road to Kibby Road for emergency access and provide bike/ped connection – make connection to existing trails on Kibby Road
24. Potential connection between neighborhoods and Township Office following sewer easement
25. Existing crossing dangerous – northbound cars turning left off of Horton onto Weatherwax do not stop for bikes/peds, there is an existing flashing beacon, but they do not see it from that angle
26. Future development may include pathway from School to Badgley Road
27. Sidepath planned for north side of McDevitt Ave as part of sewer project – travel lanes narrowed and paved shoulder removed
28. Difficult getting SRTS funds to school due to lack of sidewalks in neighborhood – at the very least, would like to see crosswalks on Badgley and 4th between neighborhoods
29. County looking at including internal trail system in Vandercook Lake County Park – provide sidewalk connection from park to school
30. Bike Union new home on Woodbridge
31. Would like to see green “family friendly” routes on S Brown, Wildwood Ave, 4th Street, and N Jackson; W 4th Street better than S West St; Wildwood Ave connects to High School; existing bike lanes on S Brown need improvement
32. W Morrell St very bad right now, needs improvement
33. W High Street - road is bad
34. Bad intersection at Brown and Morrell St
35. Priority link – complete gap in cross county trail
36. Environmental Commission (1) Water Resource Protection (2) Energy Efficiency (3) Reforestation (4) Vacant Lot (5) Recycling/Waste (6) Walkability/Nonmotorized/Transit
37. Done spend money on existing MLK trail, put down new trails
38. Need to promote trails to new users and residents
39. Need to address West Ave - high traffic corridor
40. Non-motorized improvement for Horton Road - high speed vehicles and residential neighborhoods
41. Path along Brown Lake Rd between college and Falling Waters Trail

Grass Lake

Legend:

| | |
|-------------------------------------|--------------------|
| Off-road Trail (multi-use) | existing potential |
| Paved | — |
| Unpaved | — |
| On-road Bike Route (shared roadway) | — |
| Paved | — |
| Unpaved | — |
| Bike Lane / Paved Shoulder | — |
| Sidewalks | — |
| Hiking Trails | — |
| Crosswalk Improvement | — |
| Intersections | — |

| | |
|----------------------|---|
| City / Village | — |
| Rivers, Lakes, Ponds | — |
| Wetlands | — |
| Recreation | — |
| School / Academic | — |
| Public Land | — |
| Consumer Energy | — |
| Parcels | — |
| Buildings | — |
| Townships | — |
| Schools | — |
| Golf Course | — |
| Library | — |

WOULD LIKE TO SEE BUILT FIRST

WOULD LIKE TO SEE BUILT LAST

MAP NOTES/CHANGES

GRASS LAKE - MAP NOTES/CHANGES:

1. Pathway connection along Michigan Ave to neighborhoods to the west for school children (to Breezy Lane)
2. Add crosswalk
3. Connection from Hillview Lane to Grass Lake State Game Area
4. Improve railroad crossing for pedestrians
5. Improve park trails and make connection to Winegar Road
6. Priority route – Mount Hope Road between Grass Lake and trails north of I-94; put trail on east side (more homes and future Henry Ford Medical Center)
7. Future Henry Ford Medical Center planned for southeast corner of Mount Hope Road and I-94; contact Chad Noble at HFAH about potential trails
8. Build loop around State Game Area
9. Want more sidewalks in village



Repair sidewalks

Width of sidewalks in village at least 5' wide

Improve township trails that already exist

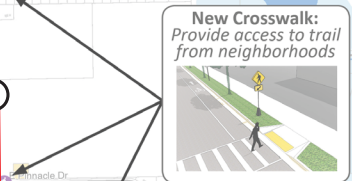
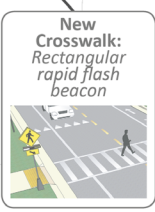

Trail over railroad tracks

Bike lane through Village

School Connection
Work with landowner to provide connection from Michigan Ave to Schools

Trail over railroad tracks

Improve crosswalk and sidewalks in grass lake

More sidewalks and safe crosswalks

Improve Crosswalks: Include detectable warning, ramps, high visibility markings, and in-street pedestrian sign to help slow traffic in the downtown and along school routes



0 0.25 0.5 Miles



Spring Arbor

Legend:

| | | |
|-------------------------------------|--------------------|----------------------|
| Off-road Trail (multi-use) | existing potential | City / Village |
| Paved | — | Rivers, Lakes, Ponds |
| Unpaved | — | Wetlands |
| On-road Bike Route (shared roadway) | — | Recreation |
| Paved | — | School / Academic |
| Unpaved | — | Public Land |
| Bike Lane / Paved Shoulder | — | Consumers Energy |
| Sidewalks | — | Parcels |
| Hiking Trails | — | Buildings |
| Crosswalk Improvement | — | Townships |
| Intersections | — | Schools |
| | | Golf Course |
| | | Library |

SPRING ARBOR - MAP

NOTES/CHANGES:

1. Western School Campus is a hub in the community – used 7 days a week; sports fields with lots of parking on game days; cross country trail
2. Potential school developed across Dearing Road – school owns property
3. Connection to Western School Campus along Dearing Road is the top priority of the community
4. Residents on Concerto Court not interested in allowing bike route through neighborhood
5. Future park with water tower; lots of topography at the north end of the property
6. Bike/Ped access from Chapel Road
7. Village owns property – plans for trail connection attend of Wakefield Cr/Richard road
8. Would like to see loop route including Chapel, 2nd St, King Rd and Dearing Street
9. Pedestrian connections along 2nd Street a top priority – a pathway would be ideal but will take whatever we can get
10. Prefer pathway along Dearing Road, not through school property
11. Bike/Ped connection to existing school on east side of Spring Arbor
12. Sidewalk connection
13. Crosswalk across M60
14. Would like to see pathway up Chapel/Michigan to school and Parma, not on Dearing
15. Would like to see crosswalk at Starr for Elementary School

Pathway Connection to Parma

May be potential for off-road trail along north side of railroad to Parma



Pathway Connection to Western High School



New Crosswalk Rectangular Rapid Flash Beacon



Local road bike route



Sidewalk Provide sidewalk connection to University from neighborhood



Sidewalk Extend to shopping center



Sidewalk Under construction by MDOT

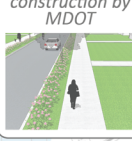

Crosswalk Improvements: Rectangular Rapid Flash Beacon with detectable warning and high visibility marking

Connection to Falling Water Trail Sidepath along Teft Road currently under development

WOULD LIKE TO SEE BUILT FIRST

WOULD LIKE TO SEE BUILT LAST

MAP NOTES/CHANGES



All neighborhoods need sidewalks

Sidewalks to Campus

Additional trails in Spring Arbor

0 0.25 0.5 Miles



Springport

Legend:

existing potential
Off-road Trail (multi-use)

Paved
Unpaved

On-road Bike Route (shared roadway)
Paved
Unpaved

Bike Lane /
Paved Shoulder

Sidewalks

Hiking Trails

Crosswalk Improvement
Intersections

City /Village
Rivers, Lakes, Ponds
Wetlands
Recreation
School / Academic
Public Land
Consumers Energy
Parcels
Buildings
Townships
Schools
Golf Course
Library

SPRINGPORT - MAP NOTES/CHANGES:

1. Potential for loops
2. Bike lane on south side
3. This crosswalk was recently moved to the west
4. Should be crosswalk
5. Top priority – paved if resources allow or crushed fines if not
6. Potential paved shoulder or path/sidewalk
7. Sidewalk gap to be complete in October of 2019
8. Mountain bike and walking trails in park
9. N Pearl Street to be paved in 2020

WOULD LIKE TO
SEE BUILT FIRST

WOULD LIKE TO
SEE BUILT LAST

MAP NOTES/
CHANGES

Complete sidewalk

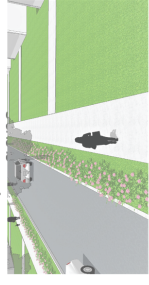

Improve Crosswalk:
detectable warning, high
visibility markings, in-
street pedestrian sign to
help slow traffic coming
into town

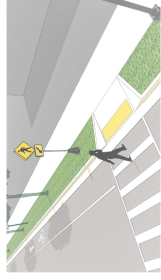

Abandoned Rail
Corridor

Work with local utility
company to provide 1-
mile trail south of town

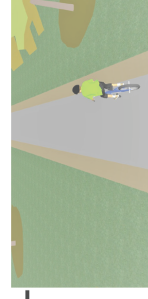

New Crosswalk

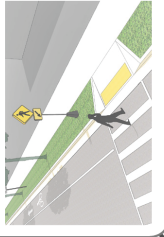

Complete sidewalk
gaps in
neighborhood
to park

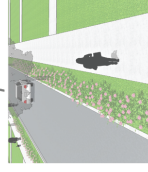

Pursue
trail along
abandoned rail
corridor if land
owners are
amenable

Village of
Springport
Property

0 0.15 0.3 Miles

